

Replacing the paper rollers

- 1 Remove Tray 2 from the front of the printer.
- 2 On Tray 2, locate the paper roller and the cover next to the roller.
- 3 Squeeze the cover release lever and open the cover.
- 4 Remove the old paper roller from Tray 2 by squeezing together the blue tabs and then sliding the roller off its spindle.

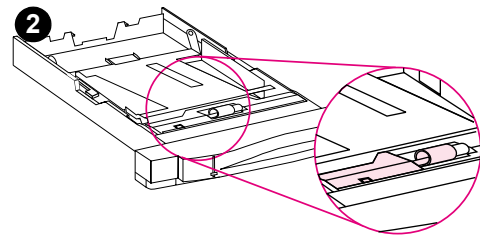

Note

The feed roller has a D-shaped hub and the separation roller has a round-shaped hub.

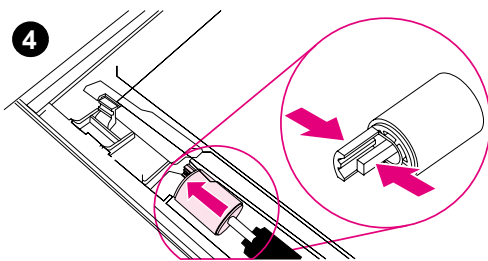
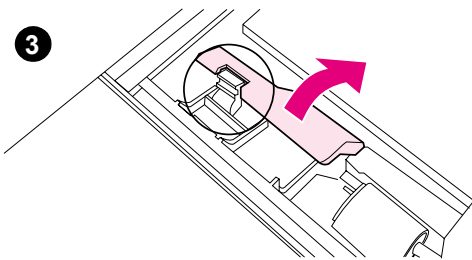

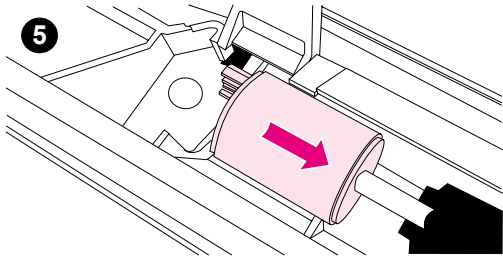

5 Install a new paper roller on Tray 2. Slide the new roller onto the spindle until the roller clicks into place.

6 Close the cover.

7 Inside the tray cavity on the printer, locate the paper roller in the top of the tray cavity.

8 Squeeze the blue tabs on the roller and remove the old paper roller from the tray cavity.

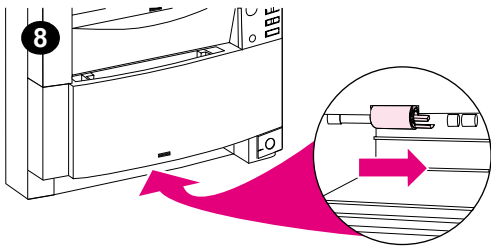
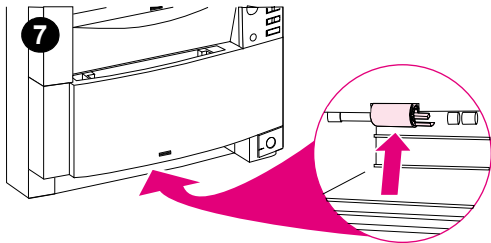
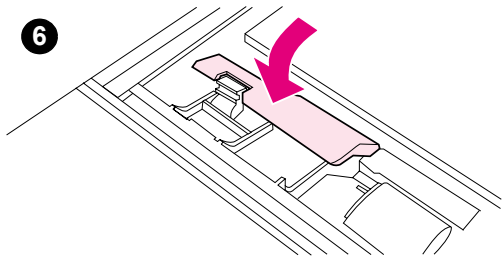

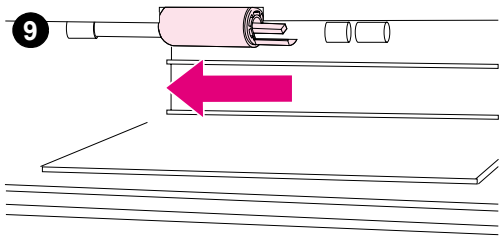

9 Install a new paper roller on the tray cavity. Slide the new roller onto the spindle until the roller clicks into place.

10 Replace Tray 2.

11 If you have the optional 500-sheet paper feeder (Tray 3), repeat steps 3 through 9 to replace the two paper rollers for Tray 3.

12 Remove the paper roller in the tray cavity for Tray 3 in the opposite direction from the paper roller in the other tray cavity.

