

Pickup roller (Tray 1)

CAUTION: Do not touch the spongy roller surface unless replacing the roller. Skin oils on the roller can cause paper pickup problems.

1. Open Tray 1.

Figure 1-66 Remove the pickup roller (Tray 1; 1 of 5)

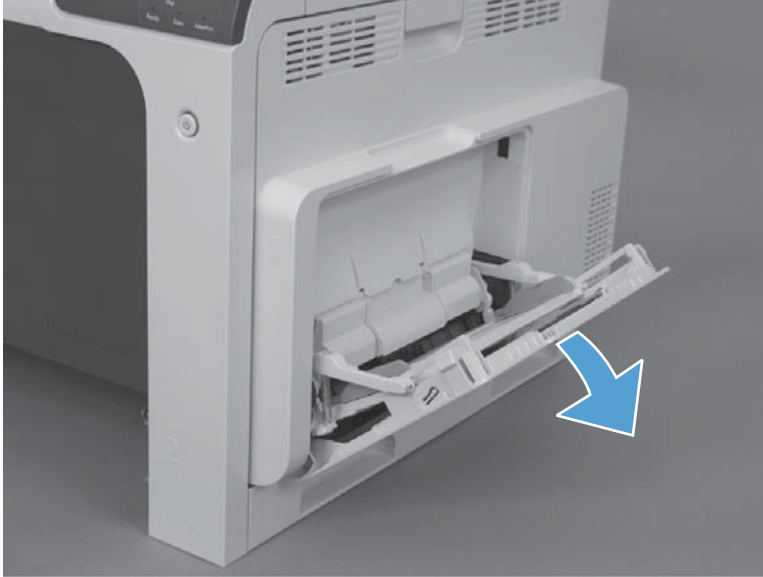

2. Push the top edge of the cover to release the tabs.

Figure 1-67 Remove the pickup roller (Tray 1; 2 of 5)



3. Open the right-door assembly, and then remove the cover.

Figure 1-68 Remove the pickup roller (Tray 1; 3 of 5)



4. Release the two blue tabs.

Figure 1-69 Remove the pickup roller (Tray 1; 4 of 5)

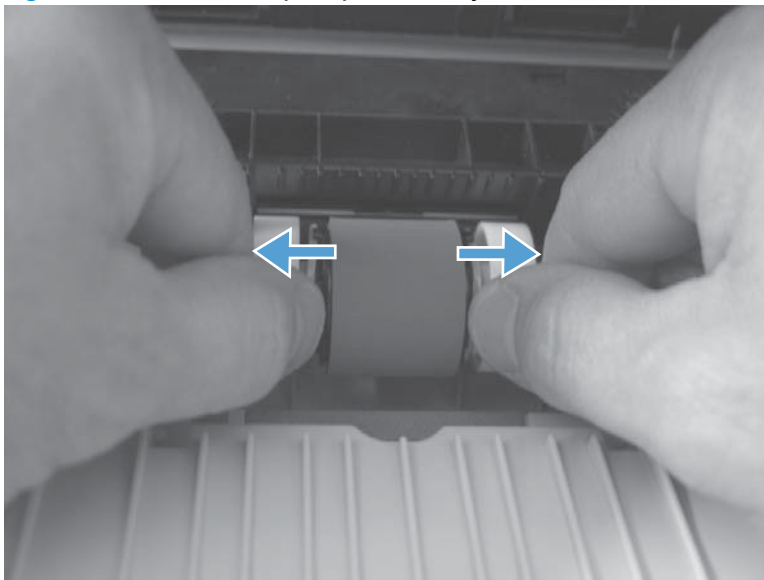

5. Rotate the roller body away from the product to remove it.

Figure 1-70 Remove the pickup roller (Tray 1; 5 of 5)



Reinstall the pickup roller (Tray 1)

- ▲ When reinstalling the pickup roller, make sure the roller cover is installed correctly. Incorrect installation can cause paper to jam.

Figure 1-71 Correct position of cover



Figure 1-72 Incorrect position of cover

